

T-BAR / PLATE

Contents

- 1x T-bar (A)
- 1x Plate (B)
- 1x Silicon washer (C)
- 1x Metal washer (D)
- 1x M5 x 30 mm screw* (E)
- 1x Coin cap installation tool** (F)
- 2x Coin cap (G)
- 2x Countersunk screw*** (+ 1 spare) (H)

*Fits doors & drawers of max 20 mm.

** Coinscrew tool **must be used by hand only.**

*** Fits doors & drawers of 16 mm and thicker.

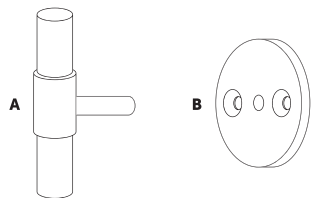

BUSTERANDPUNCH.COM

BUSTER + PUNCH

HARDWARE

T-BAR / PLATE

EUROPE INSTRUCTIONS

CARE INSTRUCTIONS

Use mild detergent and soft damp cloth



Installation

1. Pre-drill holes to prevent cracks.
2. Place plate (B), silicon washer (C), metal washer (D) and M5 screw (E) as shown in image below.

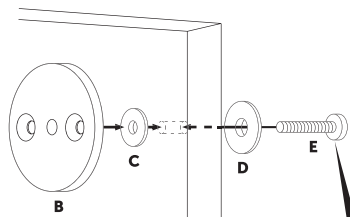

M5 screw is used to hold the plate in place while attaching countersunk screws in step 3.

3. Attach plate to door with countersunk screws.

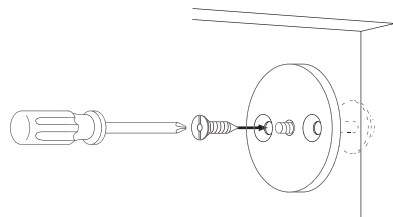

4. Attach coin caps to countersunk screws. Use coinscrew tool to tighten screws. **Please note: coinscrew tool must be used by hand only.**

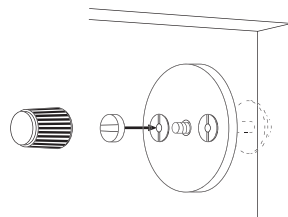

5. Attach T-bar to plate with M5 screw. For extra strong fit; hold the screw still with a screwdriver, and tighten the handle by screwing the T-bar by hand.

